

CUTWATER C-288 C

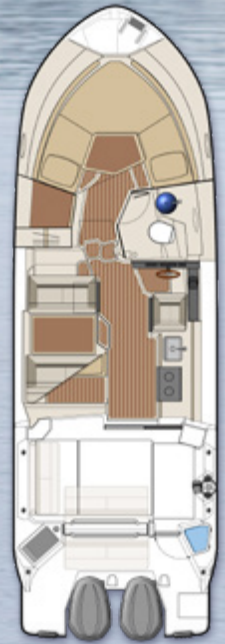

SPECIFICATIONS

Length overall (rigged)	32' 6"	9.9 m
Beam	10'	3.05 m
Bridge clearance (mast up)	11'	3.4 m
Bridge clearance (mast down)	9' 2"	2.8 m
Fuel	200 US gal	757.1 L
Water	41 US gal	155.2 L
Waste	25 US gal	94.6 L

THE NEXT GENERATION IN CRUISING DESIGN

True to the Do-It-All nature of Cutwater Boats, the C-288 Coupe is loaded with premium features as standard equipment, providing unsurpassed versatility. The contemporary Downeast design is set to turn heads wherever she'll roam, and avid cruisers appreciate the abundant power produced by the twin counter-rotating Yamaha F250 outboards.

The C-288's advanced hull design delivers the perfect blend of performance, comfort and efficiency thanks to the double-stepped deep-V hull, Laminar Flow Interrupters and a stout 10' beam. The generous beam maximizes cabin area and on-water stability while remaining trailerable.

Boarding is made safe and easy with our Clear-Path swim platform which fully wraps around the outboard engines. In the cockpit, you'll find ample storage, rod holders, beverage holders, livewell, electric grill and more. The cockpit transforms into a social space providing seating for six with the convertible sunset seat, fold down gunwale seats and an opening glass bulkhead lounge. The overhead solar panel and sport racks allow for extended cruising and storage for SUPs, kayaks, bikes and more.

Step inside the salon and you'll find your home on the water, with a full galley featuring a stovetop, stainless-steel sink with pull-out rinse faucet, fridge/freezer combo, microwave convection oven, cabinetry, and a wine/water cooler. The helm is a Captain's dream with a Garmin 8612xsv chartplotter, Garmin Autopilot, sonar, xHD radar, color engine displays and a twin-lever electronic throttle control.

You'll remain comfortable in any weather with the climate-controlled interior featuring sliding overhead hatches and opening portlights. Separate accommodations for six include a master stateroom forward, spacious mid-berth and a private head with shower. The C-288 C is the complete package for extended cruising, fishing, remote work, and more.



47 37th st NE
 Auburn, Washington, 98002
 Phone: 253.839.5213
www.CutwaterBoats.com



MADE IN USA

FEATURES

Bolded items: High value features included in the price of the Cutwater 288 C. Other manufacturers oftentimes list these features as options with an additional cost.

PERFORMANCE

Twin 250HP Yamaha F250 outboards

Double stepped hull

Electric trim tabs

Laminar flow interrupters

Bow thruster

Thruster wireless remote

Trailerable - 10' beam

ACCOMMODATIONS & INTERIOR COMFORT

Cabin drink holders

Curtains for privacy

Dinette (seats 4) converts to bed

Fully enclosed head

Fusion stereo system (multi-zone)

Hatches, pilothouse roof, solar reflective, 2

Hatches, stateroom, 2

Indirect cabin lighting

LED lighting

Electric marine toilet w/ holding tank, pump out

Midship stateroom

Opening portlights, 4

Private forward stateroom

Shower with enclosure

Storage under mattress

TV/DVD in salon

TV/DVD in stateroom

DECK FEATURES

Anchor package; 22 lb, 50' chain, 200' line

Bow beaching ladder, stainless steel

Clear Path engine rigging

Clear Path swim step

Folding stainless steel mast for trailering

Forward line storage

ReFlex high density closed cell foam decking

Rod holders

Sport racks, stainless steel

Swimming ladder, stainless steel

Swim step, with built-in fenders

Washdown system

Windlass, bow and helm controls

COCKPIT

Cockpit cover, hard-top w/ lights

Cockpit drink holders

Cockpit seating, 7+

Electric grill

Livewell

Opening glass bulkhead with reversible seat

Reversible sunset seat

Transom entry door for boarding

HELM

Color engine display

Digital fuel flow data

Electronic shift and throttle control, twin lever

Garmin 8612xsv navigation system w/ GPS and sonar

Garmin autopilot

Garmin xHD radar

Helm drink holder

USB charging ports

Windshield wipers, 2

GALLEY

Cutting board

Galley cabinets

Galley drawers

Microwave

Oven, convection/microwave

Refrigerator/freezer

Sink with hot and cold water, with pull-out rinse faucet

Stove top, propane

MECHANICAL & ELECTRICAL

AC Electrical panel

Batteries

Battery charger

DC electrical panel

Galvanic isolator

Inverter

Macerator discharge

Shore power cord(s)

Solar panel w/ controller

Underwater lights

SAFETY

Carbon monoxide detectors

Courtesy lights

Electric horn

Illuminated compass

Navigation lights

Safety kit: fenders, lines, flares, fire ext, first aid kit, life jackets, boat hook

Swim platform rails

VHF radio, DSC capable

Window defrosters

CONSTRUCTION

Bonded electrical system

Foam-filled fiberglass stringer grid system

Seawater strainer(s)

Self bailing cockpit

Stainless steel cleats, rails, hardware

Vinylester barrier coat

CUTWATER C-288 C PACKAGES - FACTORY DIRECT PRICING

The Cutwater C-288 C is sold fully equipped and ready to cruise with an expansive selection of premium features and outfitted in one of two packages:

Northwest Edition: Most commonly used in colder climates where air conditioning would not be needed or necessary. **Equipped with AGM batteries, a diesel forced air heater, and downrigger plugs & pads.**

NORTHWEST EDITION, FULLY EQUIPPED FROM: \$299,937.00*

Luxury Edition: Most commonly used in warmer climates where air conditioning is a must. **Equipped with air conditioning/reverse cycle heating, and lithium-ion battery upgrade to enable inverter powered air conditioning/reverse cycle heat.**

LUXURY EDITION, FULLY EQUIPPED FROM: \$314,937.00*

ADDITIONAL OPTIONS

Aft Cockpit sun shade with sunset shade	\$1,575
Aft Station steering with electronic controls	\$5,220
Bimini Top w/ boot	\$3,610
Aluminum triple axle trailer with electric/hyd brakes spare tire/bracket.	\$16,490
Downrigger Plugs and Pads (Luxury only, included in NW).	\$390
Factory Delivery Experience	\$3,150
Garmin GXM Weather Antenna	\$1,575
Rocket Launchers, Arch with rod holders (6).	\$1,105
Hull color upgrade (from standard White)	\$7,875

**Options, freight & taxes extra. Prices, specifications, equipment and options may change without notice. Information on this sheet should not be used for navigation. 1121*



White



Light Gray



Dark Gray



Midnight Blue