

# CUTWATER 30 S



**The Cutwater 30 Sedan (C-30 S)** is well-known for its stability, comfort, and performance. The stepped, semi-planing hull gets you up to speed quickly and efficiently while the keel aids in precision handling and offers superior drivetrain protection. The spacious C-30 S is rich with standard features that provide for comfortable onboard living. An ingenious cockpit seating arrangement welcomes up to seven adults without crowding, and a new Euro-style galley conceals appliances beneath a hinged counter-top that's ideal for buffet or refreshment service.

The Cutwater 30 accommodates six on three separate berths, for exceptional privacy and comfort even on extended cruises. On the fore deck, two flush hatches open to reveal cushioned, secure observation seats, along with a central forward lounge. Add to this a long list of other features and the reliable performance of the 440-h.p. Volvo diesel engine for efficient express service to distant waterways, and you have a masterpiece of innovation that ensures unsurpassed enjoyment, year after year.

## Specifications

LOA rigged (with swim & pulpit)	35' 8"	10.9 m
Bridge clearance (mast folded)	9' 9"	2.97 m
Beam	10'	3.05 m
Draft	29"	0.73 m
Height on trailer	13' 2"	4 m
Length on trailer	40' 2"	12.24 m
Fuel capacity	180 U.S. Gal	681.4 L
Water capacity	60 U.S. Gal	227.1 L
Holding tank capacity	40 U.S. Gal	151.4 L
Weight (dry)	10,200 lbs	4,626 kg
Engine	Volvo D6, 440 HP	Common Rail Diesel Engine

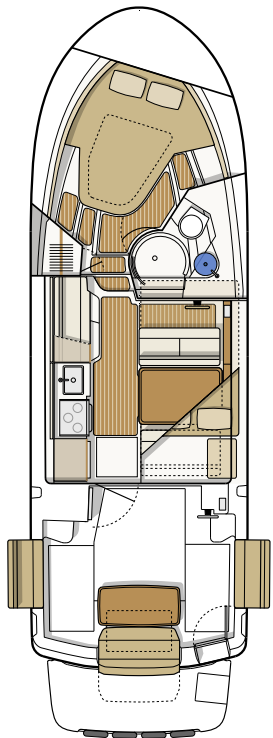

## Standard Features

### Performance

440 HP Volvo D6 diesel inboard  
**Electric trim tabs**  
 Stepped hull  
**Bow and stern thrusters**  
**Thruster wireless remote**  
 Trailerable - 10' beam



### Accommodations & Interior Comfort

Cabin drink holders, 4  
 Cabin heater (engine)  
 Curtains for privacy  
 Dinette (seats 4) converts to bed  
**Fully enclosed head**  
**Fusion stereo system (multi-zone)**  
 Hatches, pilothouse roof, solar reflective, 4  
 Hatches, stateroom, 2  
 Indirect cabin lighting  
**Island bed**  
**LED lighting**  
**Electric marine toilet w/ holding tank, pump out**  
**Memory foam mattress**  
 Midship stateroom  
 Opening portlights, 7  
 Private forward stateroom  
 Shower with enclosure  
 Storage under mattress  
**TV/DVD in salon**  
**TV/DVD in stateroom**

### Deck Features

**Anchor package, 22 lb, 50' chain, 200' line**  
 Bow lounge seating, 3  
**Bow beaching ladder, stainless steel**  
**Bow pulpit**  
 Folding stainless steel mast for trailering  
 Forward line storage  
 Rocket launchers, 6  
**ReFlex high density closed cell foam decking**  
**Rod holders, 2**  
**Sport racks, stainless steel**  
 Swimming ladder, stainless steel  
**Swim step, with built-in fenders**  
**Washdown system**  
 Windlass, bow and helm controls

### Cockpit

**Cockpit cover, hard-top w/ hatches and lights**  
 Cockpit drink holders, 4  
**Cockpit refrigerator**  
 Cockpit seating, 7+

**Cockpit sink**  
 Cockpit table  
 Fold-out gunwale seating  
**Opening glass bulkhead w/ reversible seat**  
**Powered engine hatch**  
 Reversible sunset seat  
**Transom entry door for boarding**

### Helm

**AIS receiving**  
**Color engine display**  
**Digital fuel flow data**  
**Electronic shift and throttle control, single-lever**  
**Garmin autopilot**  
**Garmin navigation system w/ GPS and sonar, 8612xsv**  
**Garmin radar, xHD**  
 Helm drink holders, 2  
 Helm seat, double  
 USB charging ports  
**Windshield wipers, 2**

### Galley

Galley cabinets, 3  
 Galley drawers, 2  
**Microwave**  
**Oven**  
**Refrigerator/freezer**  
**Sink with hot and cold water**  
**Wine/water cooler**

### Mechanical & Electrical

AC electrical panel  
**Batteries**  
**Battery charger**  
 DC electrical panel  
**Inverter**  
**Macerator discharge**  
 Seawater strainer(s)  
 Shore power cord(s)  
**Solar panel w/ controller**  
**Underwater Lights**

### Safety

Carbon monoxide detectors  
 Courtesy lights  
 Electric horn  
 Illuminated compass  
 Navigation lights  
**Safety kit: fenders, lines, flares, fire ext, first aid kit, life jackets, boat hook**  
**Spotlight with remote**  
**Swim platform rails**  
**VHF radio, DSC capable**  
 Window defrosters

### Construction

Bonded electrical system  
 Foam-filled fiberglass stringer grid system  
 Self bailing cockpit  
 Stainless steel cleats, rails, hardware  
 Vinyl ester barrier coat

## CUTWATER BOATS = MORE VALUE

**Bolded items:** High value features included in the price of the Cutwater C-30 S. Other manufacturers oftentimes list these features as options with an additional cost.

## Additional Factory Options

Aft cockpit sun and sunset shades	\$1,575
Aft cockpit bimini top with boot	\$3,610
Aft steering, second station with electronic controls	\$5,220
Aluminum triple axle trailer, electric/hydraulic brakes, spare tire w/bracket	\$16,490
Cockpit freezer in lieu of standard refrigerator	\$630
Cockpit ice maker in lieu of standard refrigerator	\$630
Dinghy, inflatable RIB 290 CSM hypalon with Weaver davits, stand-off & winch	\$6,065
Downrigger plugs and pads (LE only, included in NW)	\$390
Factory Delivery Experience	\$3,150
Garmin GXM Weather Antenna	\$1,575
Low speed module	\$2,100
Rocket launchers, arch with rod holders (6)	\$1,105
Volvo Five Year Extended Coverage	\$4,525
Hull color upgrade (from standard White)	\$7,875

## Cutwater 30 S Packages - FACTORY DIRECT PRICING

The Cutwater 30 S is sold **fully-equipped** and **ready to cruise** with an expansive collection of premium features and outfitted in one of two packages.

**Northwest Edition:** Most commonly used in colder climates where air conditioning would not be needed or necessary. **Equipped with diesel forced air heater, downrigger plugs and pads, and propane stove & oven.**

### NORTHWEST EDITION, FULLY EQUIPPED FROM:

**\$339,937.00\***

**Luxury Edition:** Most commonly used in warmer climates where air conditioning is a must. **Equipped with air conditioning/reverse cycle heating, convection oven & microwave combo, diesel generator w/ sound shield, and electric stovetop.**

### LUXURY EDITION, FULLY EQUIPPED FROM:

**\$354,937.00\***

*\*Options, freight & taxes extra.*

*Prices, specifications, equipment and options may change without notice. Information on this sheet should not be used for navigation. 0821*



47 37th st NE  
 Auburn, Washington, 98002  
 Phone 253.839.5213  
[www.CutwaterBoats.com](http://www.CutwaterBoats.com)