

# CUTWATER C-288 C



## SPECIFICATIONS

Length overall (rigged)	32' 6"	9.9 m
Beam	10'	3.05 m
Bridge clearance (mast up)	11'	3.4 m
Bridge clearance (mast down)	9' 2"	2.8 m
Fuel	200 US gal	757.1 L
Water	41 US gal	155.2 L
Waste	25 US gal	94.6 L

## THE NEXT GENERATION IN CRUISING DESIGN

True to the Do-It-All nature of Cutwater Boats, the C-288 Coupe is loaded with premium features as standard equipment, providing unsurpassed versatility. The contemporary Downeast design is set to turn heads wherever she'll roam, and avid cruisers appreciate the abundant power produced by the twin counter-rotating Yamaha F250 outboards.

The C-288's advanced hull design delivers the perfect blend of performance, comfort and efficiency thanks to the double-stepped deep-V hull, Laminar Flow Interrupters and a stout 10' beam. The generous beam maximizes cabin area and on-water stability while remaining trailerable.

Boarding is made safe and easy with our Clear-Path swim platform which fully wraps around the outboard engines. In the cockpit, you'll find ample storage, rod holders, beverage holders, livewell, electric grill and more. The cockpit transforms into a social space providing seating for six with the convertible sunset seat, fold down gunwale seats and an opening glass bulkhead lounge. The overhead solar panel and sport racks allow for extended cruising and storage for SUPs, kayaks, bikes and more.

Step inside the salon and you'll find your home on the water, with a full galley featuring a stovetop, stainless-steel sink with pull-out rinse faucet, fridge/freezer combo, microwave convection oven, cabinetry, and a wine/water cooler. The helm is a Captain's dream with a Garmin 8612xsv chartplotter, Garmin Autopilot, sonar, xHD radar, color engine displays and a twin-lever electronic throttle control.

You'll remain comfortable in any weather with the climate-controlled interior featuring sliding overhead hatches and opening portlights. Separate accommodations for six include a master stateroom forward, spacious mid-berth and a private head with shower. The C-288 C is the complete package for extended cruising, fishing, remote work, and more.



47 37th st NE  
 Auburn, Washington, 98002  
 Phone: 253.839.5213  
[www.CutwaterBoats.com](http://www.CutwaterBoats.com)



MADE IN USA

# FEATURES

**Bolded items:** High value features included in the price of the Cutwater 288 C. Other manufacturers oftentimes list these features as options with an additional cost.

## PERFORMANCE

Twin 250HP Yamaha F250 outboards

Double stepped hull

**Electric trim tabs**

Laminar Flow Interrupters

**Bow thruster**

**Thruster wireless remote**

Trailerable - 10' beam

## ACCOMMODATIONS & INTERIOR COMFORT

Cabin drink holders

Curtains for privacy

Dinette (seats 4) converts to bed

**Fully enclosed head**

**Fusion stereo system (multi-zone)**

Hatches, pilothouse roof, solar reflective, 2

Hatches, stateroom, 2

Indirect cabin lighting

**LED lighting**

**Electric marine toilet w/ holding tank, pump out**

Midship stateroom

Opening portlights, 4

Private forward stateroom

Shower with enclosure

Storage under mattress

**TV/DVD in salon**

**TV/DVD in stateroom**

## DECK FEATURES

**Anchor package; 22 lb, 50' chain, 200' line**

Bow beaching ladder, stainless steel

Clear Path engine rigging

Clear Path swim step

Folding stainless steel mast for trailering

Forward line storage

**ReFlex high density closed cell foam decking**

**Rod holders**

**Sport racks, stainless steel**

Swimming ladder, stainless steel

**Swim step, with built-in fenders**

**Washdown system**

**Windlass, bow and helm controls**

## COCKPIT

**Cockpit cover, hard-top w/ lights**

Cockpit drink holders

Cockpit seating, 7+

**Electric grill**

**Livewell**

**Opening glass bulkhead with reversible seat**

Reversible sunset seat

**Transom entry door for boarding**

## HELM

**Color engine display**

**Digital fuel flow data**

**Electronic shift and throttle control, twin lever**

**Garmin 8612xsv navigation system w/ GPS and sonar**

**Garmin autopilot**

**Garmin xHD radar**

Helm drink holder

USB charging ports

**Windshield wipers, 2**

## GALLEY

Cutting board

Galley cabinets

Galley drawers

**Microwave**

**Oven, convection/microwave**

**Refrigerator/freezer**

**Sink with hot and cold water, with pull-out rinse faucet**

**Stove top, propane**

## MECHANICAL & ELECTRICAL

AC Electrical panel

**Batteries**

**Battery charger**

DC electrical panel

**Galvanic isolator**

**Inverter**

**Macerator Discharge**

Seawater strainer(s)

Shore power cord(s)

**Solar panel w/ controller**

**Underwater lights**

## SAFETY

Carbon monoxide detectors

Courtesy lights

Electric horn

Illuminated compass

Navigation lights

**Safety kit: fenders, lines, flares, fire ext, first aid kit, life jackets, boat hook**

**Swim platform rails**

**VHF radio, DSC capable**

Window defrosters

## CONSTRUCTION

Bonded electrical system

Foam-filled fiberglass stringer grid system

Self bailing cockpit

Stainless steel cleats, rails, hardware

Vinylester barrier coat

## CUTWATER C-288 C PACKAGES - FACTORY DIRECT PRICING

The Cutwater C-288 C is sold fully equipped and ready to cruise with an expansive selection of premium features and outfitted in one of two packages:

**Northwest Edition:** Most commonly used in colder climates where air conditioning would not be needed or necessary. **Equipped with AGM batteries, a diesel forced air heater, and downrigger plugs and pads.**

**NORTHWEST EDITION, FULLY EQUIPPED FROM: \$299,937.00\***

**Luxury Edition:** Most commonly used in warmer climates where air conditioning is a must. **Equipped with air conditioning/reverse cycle heating, and lithium-ion battery upgrade to enable inverter powered air conditioning/reverse cycle heat.**

**LUXURY EDITION, FULLY EQUIPPED FROM: \$314,937.00\***

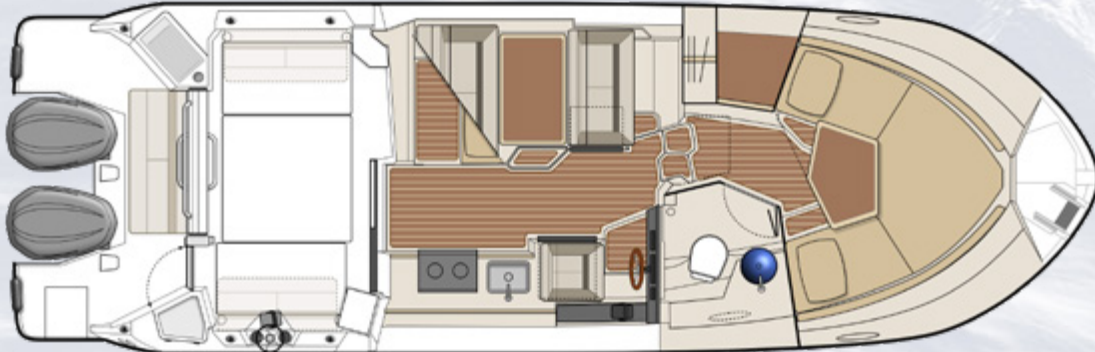

White



Light Gray



Dark Gray



Midnight Blue

## ADDITIONAL OPTIONS

Aft Cockpit sun shade with sunset shade . . . . .	\$1,575
Aft Station steering with electronic controls . . . . .	\$5,220
Bimini Top w/ boot . . . . .	\$3,610
Aluminum triple axle trailer with electric/hyd brakes spare tire/bracket. . . . .	\$16,490
Downrigger Plugs and Pads (Luxury only, included in NW). . . . .	\$390
Factory Delivery Experience . . . . .	\$3,150
Garmin GXM Weather Antenna . . . . .	\$1,575
Rocket Launchers, Arch with rod holders (6). . . . .	\$1,105
Hull color upgrade (from standard White) . . . . .	\$7,875

*\*Options, freight & taxes extra. Prices, specifications, equipment and options may change without notice. Information on this sheet should not be used for navigation. 0821*